

# SUNTOUR

## SF14-CR85-E25-R-LO-700C-40

Date	2013.6.4	Version	1
Amended			

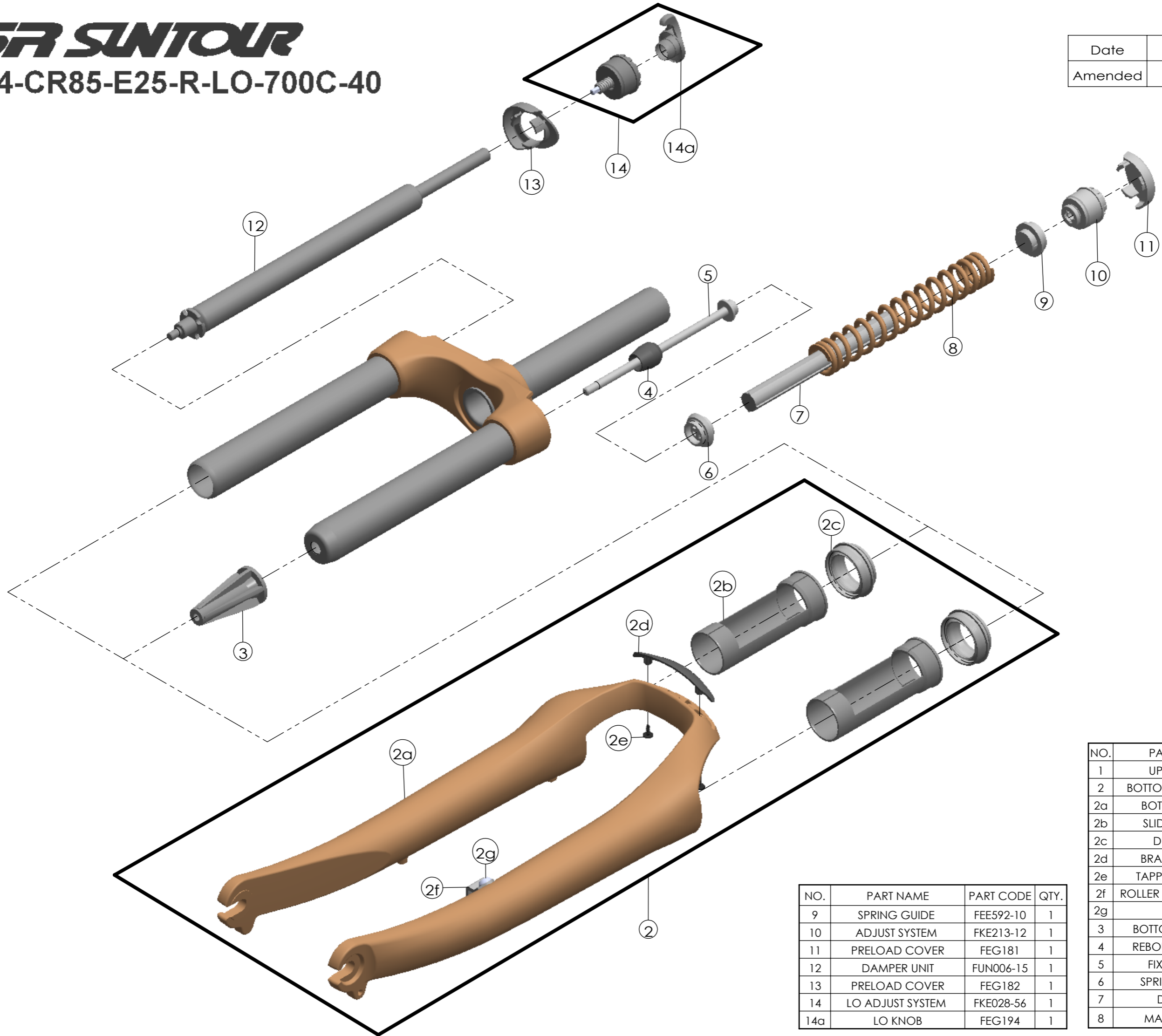

NO.	PART NAME	PART CODE	QTY.
9	SPRING GUIDE	FEE592-10	1
10	ADJUST SYSTEM	FKE213-12	1
11	PRELOAD COVER	FEG181	1
12	DAMPER UNIT	FUN006-15	1
13	PRELOAD COVER	FEG182	1
14	LO ADJUST SYSTEM	FKE028-56	1
14a	LO KNOB	FEG194	1

NO.	PART NAME	PART CODE	QTY.
1	UPPER ASSY	FKZ045-03	1
2	BOTTOM CASE ASSY	FKZ047-20	1
2a	BOTTOM CASE	FPB369	1
2b	SLIDER SLEEVE	FEG105	2
2c	DUST SEAL	FAA070-10	2
2d	BRACE COVER	FEE801	1
2e	TAPPING SCREW	FSB124	2
2f	ROLLER BRAKE MOUNT	FAA087	1
2g	BOLT	FSB061-10	2
3	BOTTOM STOPPER	FEG106-10	1
4	REBOUND RUBBER	FEP086-10	1
5	FIXING BOLT	FSB171-02	1
6	SPRING GUIDE	FEE593-10	1
7	DAMPER	FEP322-40	1
8	MAIN SPRING	FEP668	1