

Date	2013.5.13	Version	1
Amended			

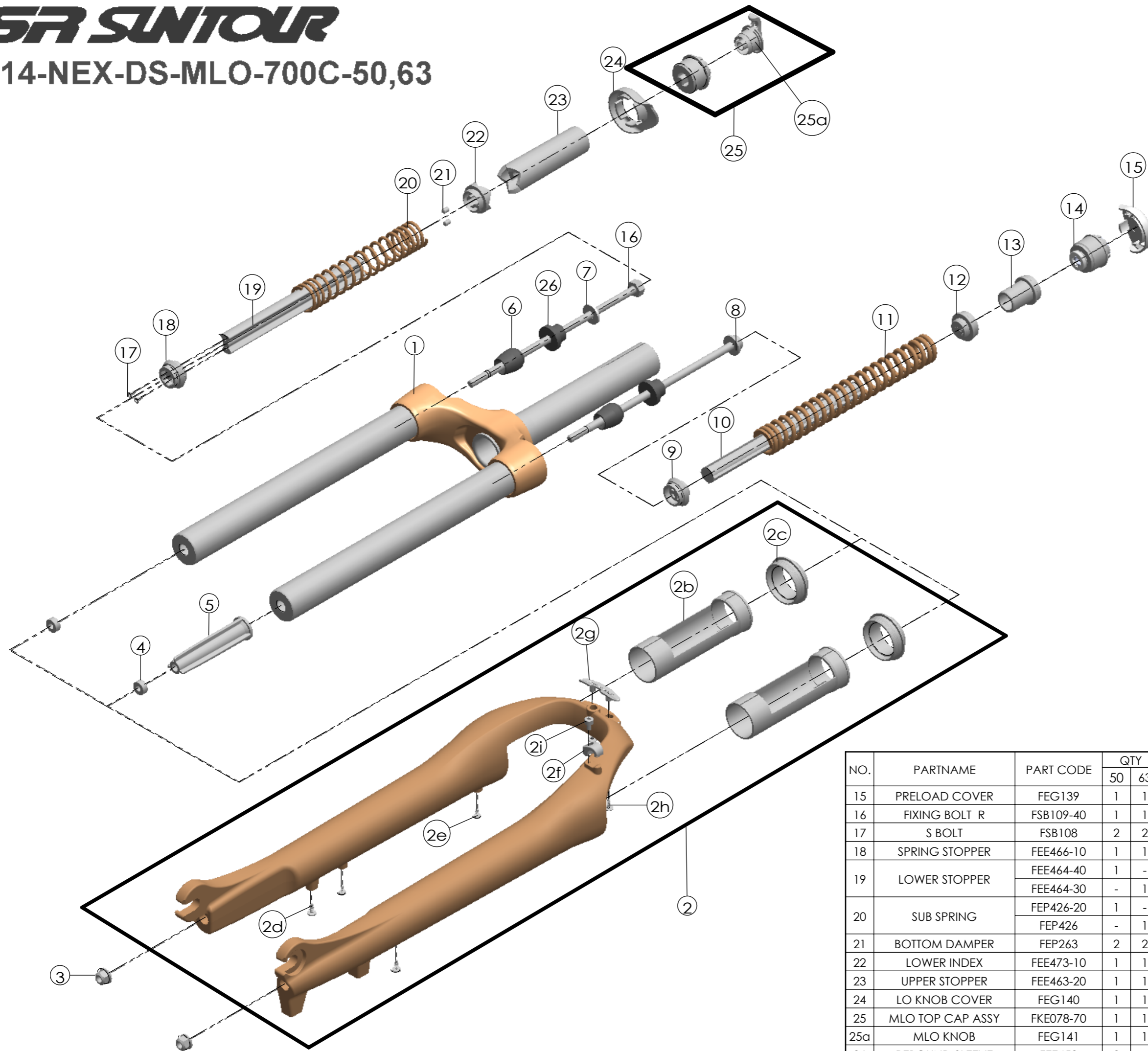

NO.	PART NAME	PART CODE	QTY.	
			50	63
1	UPPER ASSY	FKZ022-02	1	1
2	BOTTOM CASE ASSY	FKZ032-10	1	1
2a	BOTTOM CASE	FPB366	1	1
2b	SLIDER SLEEVE	FEE942	2	2
2c	DUST SEAL	FAA125-40	2	2
2d	MOUNT CAP	FAA199	2	2
2e	MOUNT CAP	FAA199-10	2	2
2f	HOSE GUIDE	FEE797	1	1
2g	BRACE COVER	FEE716	1	1
2h	TAPPING SCREW	FSB114-20	2	2
2i	FIXING BOLT	FSB153	1	1
3	FIXING NUT	FSN023	2	2
4	NUT PLATE	FSN025-10	2	2
5	BOTTOM STOPPER	FEG178	1	1
6	REBOUND RUBBER	FEP086-10	2	2
7	WASHER	FSW003	1	1
8	FIXING BOLT L	FSB159-06	1	1
9	SPRING GUIDE	FEE468-10	1	1
10	DAMPER	FEP262-95	1	-
		FEP262-50	-	1
11	MAIN SPRING	FEP442	1	-
		FEP425	-	1
12	SPRING GUIDE	FEE467-10	1	1
13	SPRING GUIDE SPACER	FEG033	1	1
14	ADJUST SYSTEM	FKE213-00	1	1
15	PRELOAD COVER	FEG139	1	1
16	FIXING BOLT R	FSB109-40	1	1
17	S BOLT	FSB108	2	2
18	SPRING STOPPER	FEE466-10	1	1
19	LOWER STOPPER	FEE464-40	1	-
		FEE464-30	-	1
20	SUB SPRING	FEP426-20	1	-
		FEP426	-	1
21	BOTTOM DAMPER	FEP263	2	2
22	LOWER INDEX	FEE473-10	1	1
23	UPPER STOPPER	FEE463-20	1	1
24	LO KNOB COVER	FEG140	1	1
25	MLO TOP CAP ASSY	FKE078-70	1	1
25a	MLO KNOB	FEG141	1	1
26	REBOUND SLEEVE	FEE452	2	-

NO.	PARTNAME	PART CODE	QTY	
			50	63
15	PRELOAD COVER	FEG139	1	1
16	FIXING BOLT R	FSB109-40	1	1
17	S BOLT	FSB108	2	2
18	SPRING STOPPER	FEE466-10	1	1
19	LOWER STOPPER	FEE464-40	1	-
		FEE464-30	-	1
20	SUB SPRING	FEP426-20	1	-
		FEP426	-	1
21	BOTTOM DAMPER	FEP263	2	2
22	LOWER INDEX	FEE473-10	1	1
23	UPPER STOPPER	FEE463-20	1	1
24	LO KNOB COVER	FEG140	1	1
25	MLO TOP CAP ASSY	FKE078-70	1	1
25a	MLO KNOB	FEG141	1	1
26	REBOUND SLEEVE	FEE452	2	-