

# SUNTOUR

SF18RUX38 boost-R2C2-PCS-  
27.5-200-QR-TS

Date	2018.-4.20	Version	3
Amended	2019.-7.-2		

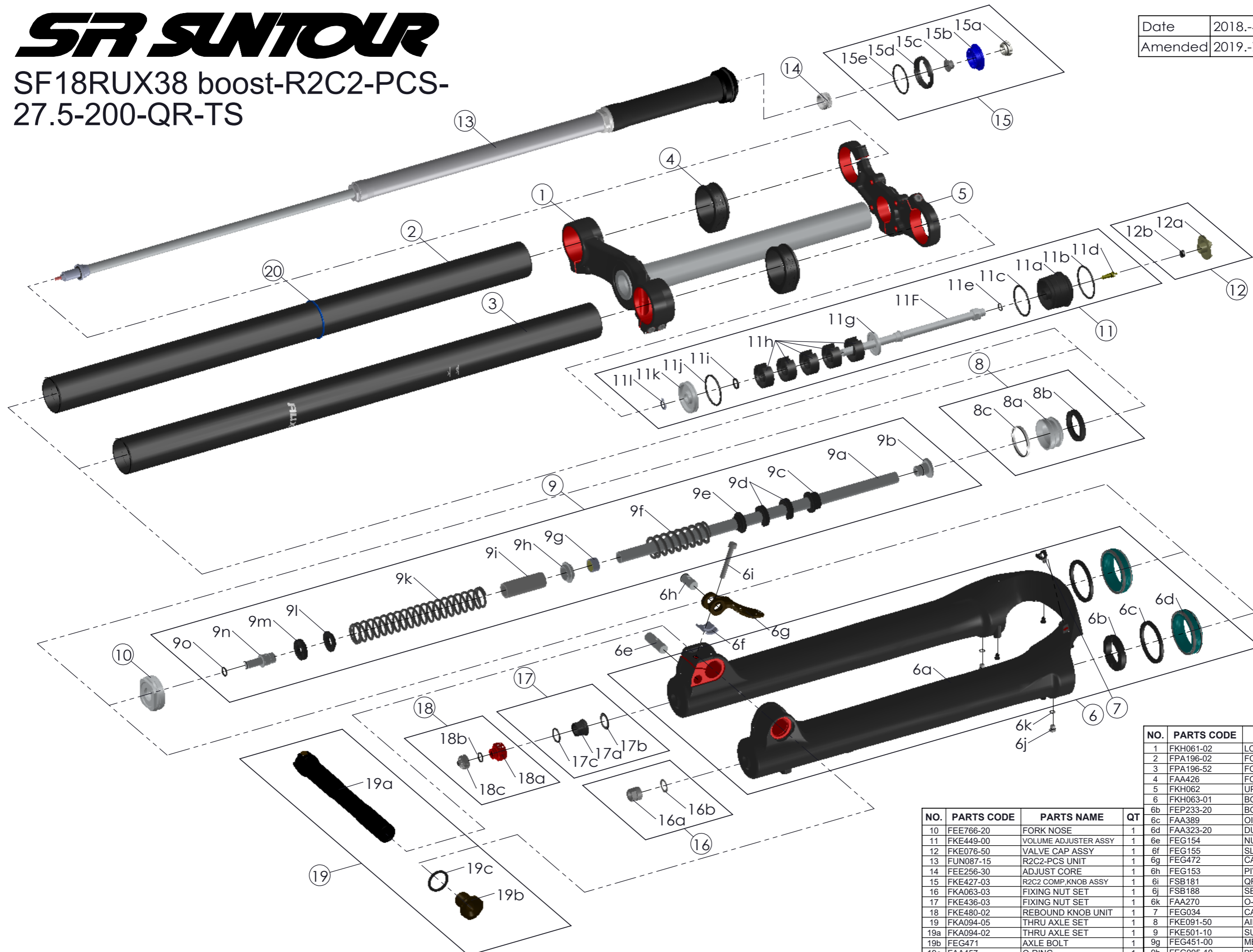

NO.	PARTS CODE	PARTS NAME	QT
1	FKH061-02	LOWER CROWN ASSY	1
2	FPA196-02	FORK PIPE R	1
3	FPA196-52	FORK PIPE L	1
4	FAA426	FORK BUMPER	2
5	FKH062	UPPER CROWN ASSY	1
6	FKH063-01	BOTTOM CASE ASSY	1
6b	FEP233-20	BOTTOM BUMPER	1
6c	FAA389	OIL WIPER	1
6d	FAA323-20	DUST SEAL	1
6e	FEG154	NUT	1
6f	FEG155	SLIDER	1
6g	FEG472	CAM LEVER	1
6h	FEG153	PIVOT	1
6i	FSB181	QR FIXING BOLT	1
6j	FSB188	SEAL SCREW	1
6k	FAA270	O-RING	1
7	FEG034	CABLE CLIP	1
8	FKE091-50	AIR PISTON UNIT	1
9	FKE501-10	SUPPORT TUBE ASSY	1
9a	FKA094-02	THRU AXLE SET	1
9b	FKA094-05	THRU AXLE SET	1
9c	FEG451-00	METAL BUSHING	1
9d	FEG095-10	REBOUND SPRING GUIDE 2	1
9e	FEP692	REBOUND SPRING LOWER	1
9f	FEE766-20	FORK NOSE	1
9g	FKE449-00	VOLUME ADJUSTER ASSY	1
9h	FKE076-50	VALVE CAP ASSY	1
9i	FEG155	SLIDER	1
9j	FEG472	CAM LEVER	1
9k	FUN087-15	R2C2-PCS UNIT	1
9l	FEE256-30	ADJUST CORE	1
9m	FKE427-03	R2C2 COMP.KNOB ASSY	1
9n	FKA063-03	FIXING NUT SET	1
9o	FKE436-03	FIXING NUT SET	1
9p	FKE480-02	REBOUND KNOB UNIT	1
9q	FKA094-02	THRU AXLE SET	1
9r	FKA094-05	THRU AXLE SET	1
9s	FEG451-00	METAL BUSHING	1
9t	FEG095-10	REBOUND SPRING GUIDE 2	1
9u	FEP692	REBOUND SPRING LOWER	1