

SR SUNTOUR

SF18RUX38 boost-RC2-PCS-
27.5-200-T-TS

Date	2018.-4.20	Version	4
Amended	2019.-7.-2		

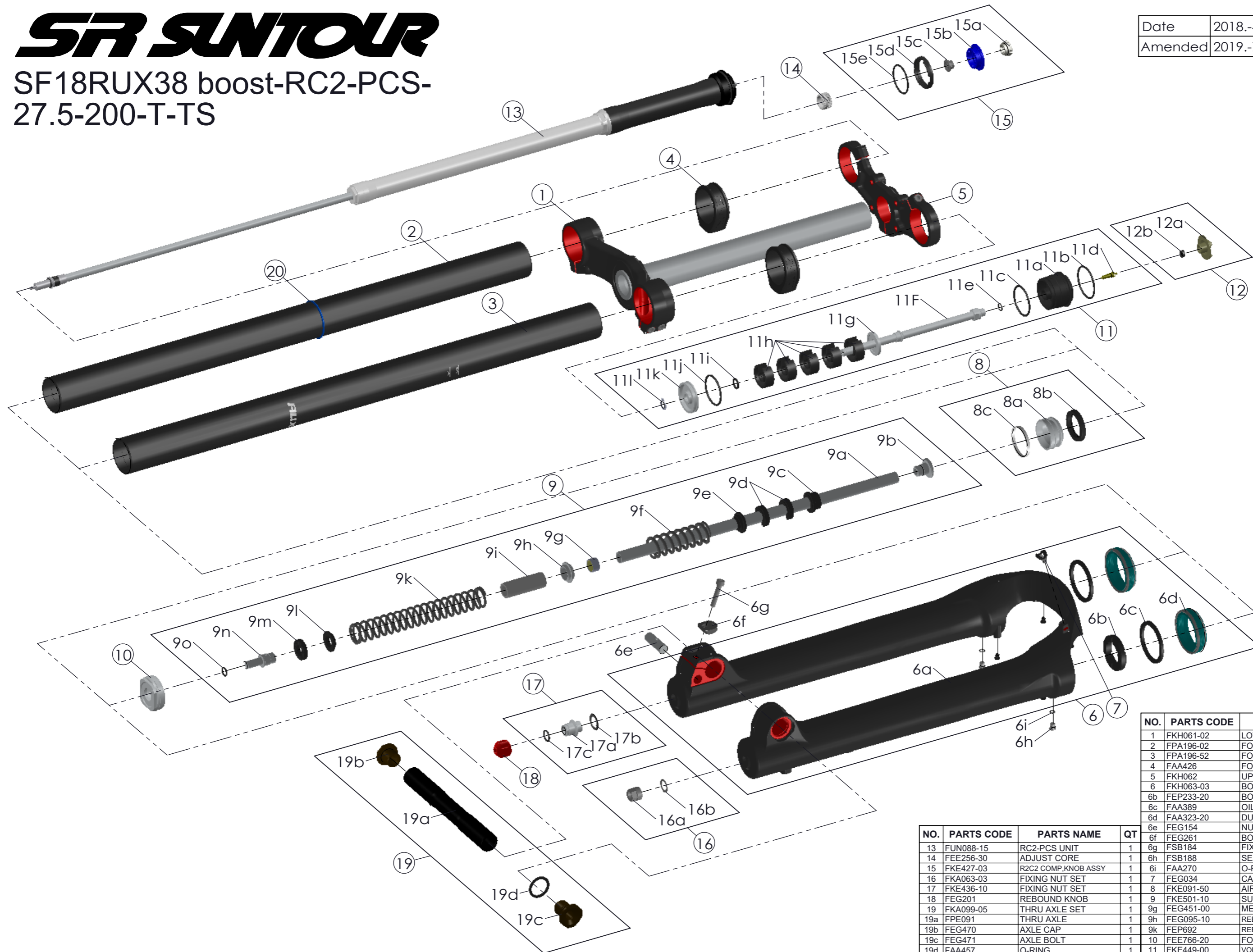

NO.	PARTS CODE	PARTS NAME	QT
1	FKH061-02	LOWER CROWN ASSY	1
2	FPA196-02	FORK PIPE R	1
3	FPA196-52	FORK PIPE L	1
4	FAA426	FORK BUMPER	2
5	FKH062	UPPER CROWN ASSY	1
6	FKH063-03	BOTTOM CASE ASSY	1
6b	FEP233-20	BOTTOM BUMPER	1
6c	FAA389	OIL WIPER	1
6d	FAA323-20	DUST SEAL	1
6e	FEG154	NUT	1
6f	FEG261	BOLT HOLDER	1
6g	FSB184	FIXING BOLT	1
6h	FSB188	SEAL SCREW	1
6i	FAA270	O-RING	1
7	FEG034	CABLE CLIP	1
8	FKE091-50	AIR PISTON UNIT	1
9	FKE501-10	SUPPORT TUBE ASSY	1
9g	FEG451-00	METAL BUSHING	1
9h	FEG095-10	REBOUND SPRING GUIDE 2	1
9i	FEG470	AXLE CAP	1
9k	FEG471	AXLE BOLT	1
10	FAA457	O-RING	1
11	FKE449-00	VOLUME ADJUSTER ASSY	1
12	FKE076-50	VALVE CAP ASSY	1

NO.	PARTS CODE	PARTS NAME	QT
13	FUN088-15	RC2-PCS UNIT	1
14	FEE256-30	ADJUST CORE	1
15	FKE427-03	R2C2 COMP.KNOB ASSY	1
16	FKA063-03	FIXING NUT SET	1
17	FKE436-10	FIXING NUT SET	1
18	FEG201	REBOUND KNOB	1
19	FKA099-05	THRU AXLE SET	1
19a	FPE091	THRU AXLE	1
19b	FEG470	AXLE CAP	1
19c	FEG471	AXLE BOLT	1
19d	FAA457	O-RING	1
20	FAA397-20	O-RING	1