

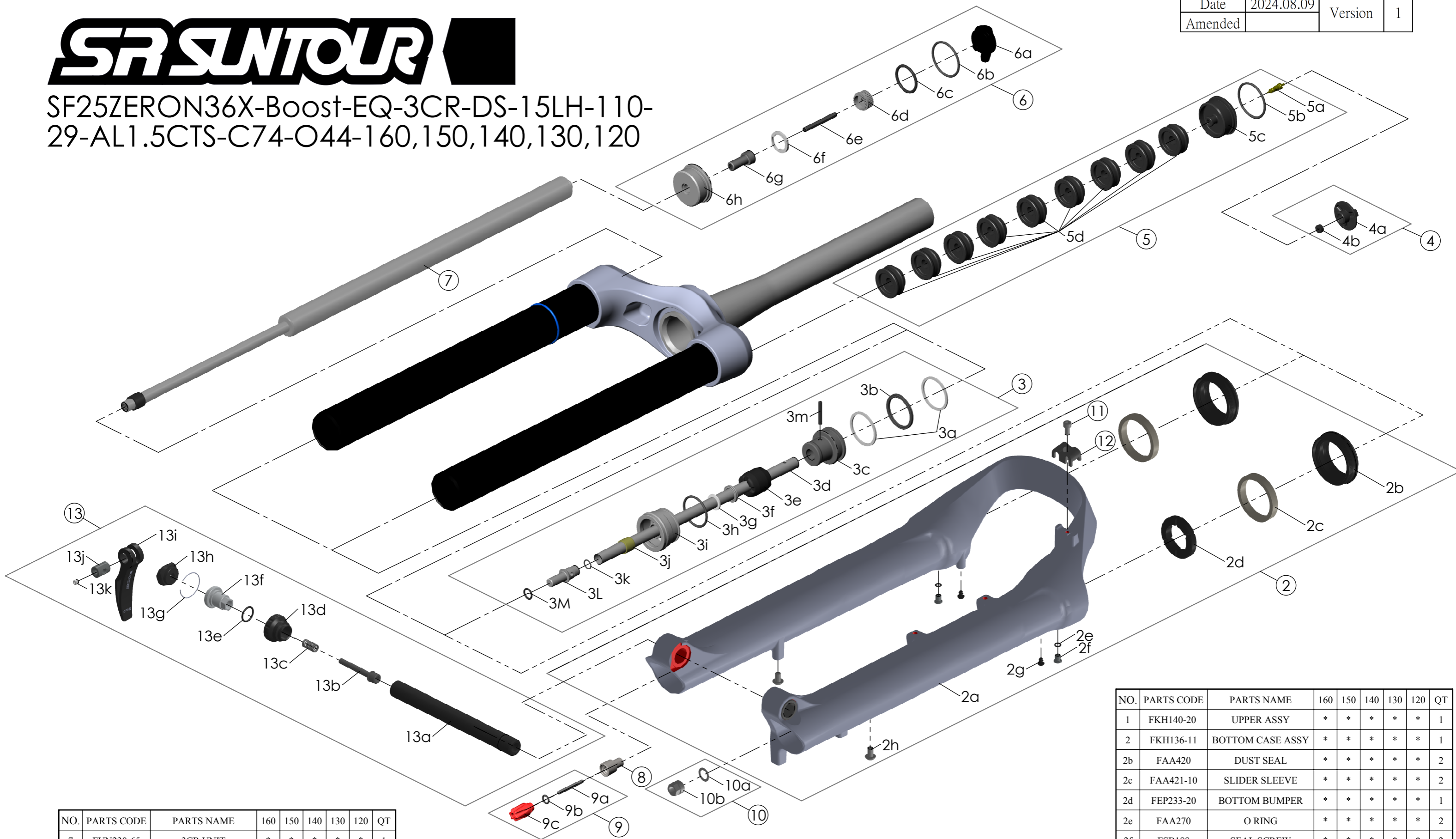

SF25ZERON36X-Boost-EQ-3CR-DS-15LH-110-29-AL1.5CTS-C74-O44-160,150,140,130,120

Date	2024.08.09	Version	1
Amended			



NO.	PARTS CODE	PARTS NAME	160	150	140	130	120	QT
7	FUN230-65	3CR UNIT	*	*	*	*	*	1
8	FSB058	DAMPER FIXING BOLT	*	*	*	*	*	1
9	FKA004-22	DAMPER KNOB ASSY	*	*	*	*	*	1
10	FKA063-03	FIXING NUT SET	*	*	*	*	*	1
11	FEF519	CABLE GUIDE	*	*	*	*	*	1
12	FSB153	GUIDE FIXING BOLT	*	*	*	*	*	1
13	FKA116-02	15LH-110 AXLE SET	*	*	*	*	*	1
14	FAA397-40	O RING	*	*	*	*	*	1

NO.	PARTS CODE	PARTS NAME	160	150	140	130	120	QT
			*					5
				*				6
5f	FEG270	VOLUME REDUCER			*			7
						*		8
							*	9
6	FKE596-00	3CR TOP CAP ASSY	*	*	*	*	*	1

NO.	PARTS CODE	PARTS NAME	160	150	140	130	120	QT
4	FKE595	VALVE CAP ASSY	*	*	*	*	*	1
	FKE594-02		*					1
	FKE594-12			*				2
5	FKE594-22	AIR CAP ASSY			*			2
	FKE594-32					*		1
	FKE594-42						*	2

NO.	PARTS CODE	PARTS NAME	160	150	140	130	120	QT
1	FKH140-20	UPPER ASSY	*	*	*	*	*	1
2	FKH136-11	BOTTOM CASE ASSY	*	*	*	*	*	1
2b	FAA420	DUST SEAL	*	*	*	*	*	2
2c	FAA421-10	SLIDER SLEEVE	*	*	*	*	*	2
2d	FEP233-20	BOTTOM BUMPER	*	*	*	*	*	1
2e	FAA270	O RING	*	*	*	*	*	2
2f	FSB188	SEAL SCREW	*	*	*	*	*	2
2g	FAA200-10	MOUNT CAP	*	*	*	*	*	2
2h	FSB203	FIXING BOLT	*	*	*	*	*	2
	FKE627-00		*					1
	FKE627-01			*				1
3	FKE627-02	AIR CYLINDER ASSY			*			1
	FKE627-03					*		1
	FKE627-04						*	1